

SUPPLEMENTARY REGULATIONS



6th and 7th of June 2025

Circuit de Spa-Francorchamps



Article 1 - PUBLICATION

Name of the Event: **8H Spa EWC Motos**

National Sporting Authority:

Fédération Motocycliste de Belgique asbl. Chaussées de Louvain 550 boîte 7 à 1030 Bruxelles

Tel: +32 2 736 53 97

International Sporting Authority:

Fédération Internationale de Motocyclisme 11 Route Suisse – 1295 Mies (Switzerland)

Tel: +41 22 950 95 00

Definition of the Event:

International event counting for the 2025 FIM Endurance World Championship and Cup.

This event will be held on 6th and 7th, June 2025.

It is entered in the FIM Calendar with ref IMN 104/02

Organizer:

PHA – Claude MICHY

Address:

PHA

15 bis place Renoux

63000 Clermont-Ferrand

France

Article 2 - SECRETARIAT OFFICE OF THE ORGANISATION

PHA

15 bis place Renoux

63000 Clermont-Ferrand

France

During the event

Le Circuit de Spa-Francorchamps,

55, route du Circuit

4970 STAVELOT

Belgium

E-mail: event@pha-michy.com

Article 3 - CIRCUIT

Length of Circuit Spa-Francorchamps: 6,985 km / 4,340 miles (Appendix 11).

The race will be run clockwise during 8 hours.

Access to the Circuit for teams' setup will be authorized exclusively by Blanchimont entrance from Tuesday June 3th, 09.00 a.m. (Appendix 14) The positioning of the competitors in the pits and in the paddock will be subject to prior authorization from the organization. An hourly convocation of each competitor may be imposed by the organizer. In the event of non-compliance with the convocations, sanctions may be taken (report from the organizer to the sporting authority).

Leaving the Circuit: Paddock and boxes must be vacated by noon on Sunday (12.00) at the latest to allow the site to be cleaned and to avoid blocking the following users from setting up

It is forbidden to fit any metal objects in our asphalt surfaces such as tent pegs, nails...

In case of non-respect, sports or financial penalties will be applied.

It is formally forbidden to use the track or its immediate approaches with any machine whatsoever, except during Practice Sessions and Races

Article 4 - JURISDICTION

The Event will be organized in accordance with the Endurance World Championship and Cup Regulations of the FIM, the prescriptions of the CCR/FIM, and with these Supplementary Regulations. The organizer also undertakes to respect as much closely as possible the FIM Environmental Management Plan.

Article 5 - OFFICIELS

PERMANENT OFFICIALS / INTERNATIONAL JURY

Race Direction

Race Director : Patrick COUTANT

Safety Officers FIM : Jean-Marc DELETANG

Discovery Sports Events Representatives Doriano VALERIANI – Renaud JEANFILS

FIM EWC Stewards

FIM EWC Chief Steward: Simon MAAS

FIM EWC Steward 2 nominated by FIM : Gerry BRYCE

FIM EWC Steward 3 nominated FIM : Arjan VAN EEKELEN

FIM EWC Steward 4 nominated FIM : Tony JACOBSSON

Appeal Steward panel

Appeal Steward nominated by the FIM: Daire LOWE

Appeal Steward nominated by the FMB: Philippe DOBBELAERE

FIM Technical Directors: Bernd SCHENKHUT – Miguel SANCHEZ

FIM Medical Director: David McMANUS

FIM Sustainability Steward: Laurent DELBROEK

Secretary of the Jury: Stijn RENTMEESTERS

DELEGATED OFFICIALS

Clerk of the Course DEQUESNE Jean-Luc

Deputy Clerk of the Course: DUFLOU Cédric

Environment steward: Olivier Martin

FMB Scrutineer officer: ROELS Patrick

Secretary of the scrutineering: TBA

Track Safety Officer: BAILLY Quentin - Circuit Spa-Francorchamps

Medical Chief Officer Dr Stéphane DEGESVES

Timekeeping: ITS EVENTS – Sébastien MASCRET

Representative of the Organisation: Claude MICHY

Article 6 - NUMBER OF MOTORCYCLES ADMITTED

Motorcycles admitted to practices and race: 60 (subject to the homologation of the circuit)

Article 7 - ENTRIES - RIGHTS

The Selection Committee composed with 4 representatives of: PHA-/ FIM / FMB and Discovery Sports Events will carry out, on the basis of the entry request received at the closing date, a selection of 60 teams invited to attend the Administrative Checks and the Scrutineering

The entries must be made according to the following priority: FIM Endurance Regulations Article 1.10.8: 2 places will be granted for teams entering a machine in the "Experimental" class provided that they meet the requirements of Article 2.9 and the agreement of the FIM Endurance Technical Director.

The Selection Committee reserves the right to refuse an entry if there is a financial dispute with PHA or the FIM prior to the

event.

The selection Committee reserves the right to refuse an entry, even if received within the deadline.

Request for entry must be made on the official Entry forms of the organizer (PHA):

https://eventrack.io/ewc/login/team_manager

➔ **Closing Date: 12 MAY 2025, midnight**

Entry forms must be enclosed with the following documents:

- The proof of payment (copy of the bank transfer).
- The information form (attached with the entry form) which must be carefully filled in, otherwise the entry request will not be considered.
- The records of wins certified and provided by the FMN, for all the riders.
- **For the team's registration, the entry form must include, at the least, the name of 2 riders for the 8H races. The riders must be part of the team registered at the administrative control, except in the case of force majeure**

The fees per 2 000 and by means of only by 12 the latest, the entry considered Selection (Bank refused).-

Crédit Mutuel						
RELEVÉ D'IDENTITÉ BANCAIRE						
Identifiant national de compte bancaire - RIB						
Banque	Guichet	N° compte	Clé	Devise	Domiciliation	
10278	11608	00020140919	58	EUR	CCM CHAMALIERES	
Identifiant international de compte bancaire						
IBAN (International Bank Account Number)						
FR76	1027	8116	0800	0201	4091	958
BIC (Bank Identifier Code)						
CMCIFR2A						
Domiciliation						
CCM CHAMALIERES 30 B AVENUE DE ROYAT 63400 CHAMALIERES 04 73 30 91 60						
Titulaire du compte (Account Owner)						
PHILIBERT ET ASSOCIES MR CLAUDE MICHY 19 RUE DU PORT 63000 CLERMONT FERRAND						
Remettez ce relevé à tout autre organisme ayant besoin de connaître vos références bancaires pour la domiciliation de vos virements ou de prélèvements à votre compte. Vous éviterez ainsi des erreurs ou des retards d'exécution.						
PARTIE RESERVEE AU DESTINATAIRE DU RELEVÉ						

participation motorbike is € must be paid credit transfer MAY 2025 at failing which will not be by the Committee check will be

WITHDRAWAL

Any declared withdrawal is irrevocable. The Team Manager of the Team must give written notification to Discovery Sports Events, by email: operations@fimewc.com

In this case, the entry fee (€ 2 000) shall be retained by the organizer.

An entry request becomes definitive only after the Entry form, the entry fee and the deposit have been received and becomes an Official Entry only after the invitation have been received by the Organizer for the Administrative checks and Scrutineering.

Article 8 - ADMINISTRATIVE CHECKS, SCRUTINEERING AND BRIEFINGS

Administrative Checks Digital scrutineering:

Technical Scrutineering:

Wednesday June 4th - Place: In the **teams'** garages

Timetable: **9.00 am - 18.00 pm** according to the scrutineering timetable

Please respect your allocated times

Team Managers & Riders' Briefing:

Thursday June 5th from 6.30 pm to 7.15 pm - CIRCUIT, LOCAL 132

Mandatory briefing for all team managers and for riders who have not participated in a FIM World Endurance Championship round in 2025.

Article 8.1 - Pit allocation (stands)

The Pit allocation is subject to various criteria.

The Championship standings at the end of the 24 Hours of Le Mans will determine the priority order for the selection of the Pits.

In addition, permanent teams will have priority over teams registered only for the 8 Hours of Spa.

Since the number of Pits is limited, some Pits may have to be shared between two teams.

Article 9 - OFFICIAL TIMEKEEPING TRANSPONDER

Competitors must install the rental timekeeping transponder provided by the Organiser on the motorcycle. Rental transponder will be remitted by the timekeeping company (ITS EVENTS), during the Scrutineering

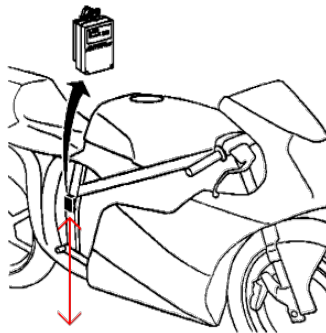

Must be installed not higher than 60 cm from the ground surface.

Please note that it may not be possible to record a time if the official timekeeping transponder is not mounted in a correct manner/position.

The team will have to give back the timekeeping transponders to the timekeeping company (ITS Chrono) (1st floor of the Pit Building – Room 120) put at their disposal, either after withdrawal or at the latest 10 minutes after the end of the race, if the motorcycle has finished the race.

In the case of non-return of this equipment, the unreturned item will be deducted from the technical costs deposit.

Article 10 - OFFICIAL GPS TRANSPONDER

GPS transponder (Atlas 2.4) supplied by the Organisers and/or the Official Time Keeping service is mandatory for all teams. This GPS transponder is used for the Race Direction and for media and promotional purposes.

All motorcycles which take the start of the race must be equipped with the official operational GPS transponder (mounted according to the official Timekeeper' instructions: ref. Appendix 7 of the supplementary regulations).

Any other GPS transponder than the official one is not permitted (except for the Championship compulsory contracted devices or/and except when mentioned in the Supplementary Regulations).

Article 11 - STARTING PROCEDURE (« LE MANS » TYPE)

Start ceremony: the Competitors and the riders have to be available and absolutely respect the program of all the planned ceremonies by the Organizer (protocol announced in the Riders' and Team managers' briefing).

Article 12 - ASSISTANCE DURING THE RACE

If a team so wishes, it can ask for assistance for the rider and its motorcycle to be taken back in a vehicle provided by the organizers.

In that case, both will be dropped at a location to be confirmed during the briefing.

From this point, 2 people from the team are allowed to bring the machine back to the pits under a track marshal control.

His lap will not be counted in his end-of-race total. If several teams ask for such assistance following a problem involving a number of riders, the teams will be assisted in the order of the starting grid.

Vehicles will be available on the track for this use.

No other assistance than the one from the organizers will be permitted.

Article 13 - FUEL AND REFUELING

The fuel used must comply with FIM regulations..

Control of the refuelling systems:

The refuelling systems (**FIM Homologated**) will be checked by the scrutineers.

All refuelling systems will be obligatory checked on **Wednesday 4 June from 9.00 p.m. to 4.00 p.m.**

Should the refuelling system not have been approved by the FIM Technical Directors, the competitors will not be able to take part in the free practice sessions on Friday June 6nd.

Refuelling operations must comply with the FIM Endurance World Championship Regulations in force.

The storage of fuel in the stand may not exceed 60 litres (derrick content included).

It is strictly forbidden to smoke in front and the stands.

It is prohibited for the person assigned to the fire safety to wear official fireman uniform.

Lighting devices cannot be fixed on the support of the autonomous fuel tank.

Any electrical installation located at less than 3 meters from the autonomous pit tank must be anti- explosion. Only low temperature and anti-explosion lights are authorised, halogen lights are forbidden

Refueling System

Refer to article 2.3.15 of the 2025 FIM Endurance World Championship Regulations as well as to the « Refueling System », Appendix 09)

In the event of non-compliance, penalties may be imposed by the FIM EWC Stewards.

Article 14 - LIGHTNING SYSTEM (Production Category only)

For the **Production Category only**, and for **Spa event only**, the rules concerning the lightning system are as per below:

- Headlights are not mandatory, but headlight stickers are mandatory.
- Electroluminescent numbers are not mandatory, but the number plates must be in conformity with all other requirements specified in the article 2.3.12.
- Rear lights are mandatory and must be in conformity with the point 4 and/or point 8 of the article 2.3.11.
- The rear light must be either: lit ('on') with the command 'engine start' before the motorcycle is moving and the rider leaves the pit box, or lit ('on') continuously and powered by the battery (main or additional battery, with or without switch).

Article 15 - PRIZE-GIVING AND CUPS

Trophies and Cups will be presented on the Podium.

Article 16 - PROTESTS AND APPEALS

The protests and appeals will be formulated in accordance with the 2025 FIM Endurance World Championship, Cup and Trophy Regulations.

Article 17 - INSURANCE

By approving of the entry form, the riders' FMN of the rider certifies that he is personally insured in compliance with the FIM Code.

The organiser has taken out an insurance policy covering the liability of the riders in the event of accident (s) occurring during the Event (both the race and the practice sessions). A copy of the contract is available upon request. The organiser can not to be held responsible for damages caused to a motorcycle, accessories or equipment through accident, fire or any other causes.

Article 18 - RELINQUISHING ALL RIGHT OF APPEAL AGAINST THE SPORTING AUTHORITIES

Independently of the FIM Sporting Code status, riders by the mere fact of their participation, waive their rights of appeal against the organisers, its representatives or employees, whether through arbitration, law courts, or any other means not

specified in the FIM Sporting Code, for any damage to which they may be exposed as a result of any act or omission committed by the organiser, his officials, representatives or employees, in the application of these rules, or any rules which might be brought into effect at a later date, or for any cause which may be a result of this.

Article 19 - POSTPONEMENT/Cancellation of the Event

Should circumstances or safety reasons demand it, the 8H Spa EWC Motos Event could be postponed or cancelled. For this the PHA organiser will not be held responsible. Should this occur, the association undertakes to refund only the entry fee.

Supplementary regulations approved by the FIM, 15 May 2025

8 HOURS OF SPA MOTOS

ANNEXES



1 - SIGNALLING AREA

The signalling area is in the pit lane.

Signalling:

The maximum dimensions possible for signalling facilities are the following:

Height : 2.00 m above track level,

Width: 2.00 m along the signalling wall,

Depth: 1.00 m from the wall track side

The timing pit board cannot exceed the glass protection. Under no circumstances, can it be positioned above the glass. No drilling is allowed on the supporting frame of the glass protection.

Penalties: at the discretion of the FIM EWC Stewards.

2 - PIT AREA

It is regulated and controlled.

The wearing of the helmet is mandatory in the pit lane during the practice sessions and the race.

Pit Stops: the team members holder of the official credentials are permitted in the working area in front of their pit box only just before working on the motorcycle. They must leave the pit- lane as soon as the work is finished.

Except during these interventions, the team members cannot stay in the pit lane.

3 - ADVERTISING

Advertising on motorcycles and on riders' overalls must comply with the FIM/FMB regulations.

Advertising and promotional action or public relations is possible after a written agreement with the Circuit Spa-Francorchamps and PHA.

4 – PASSES/ACCREDITATION

The teams under contract will receive their passes from the Promoter of the FIM Endurance World Championship, Cup and Trophy.

Other teams will get a maximum of 30 passes per motorcycle, admitted to take part in the practice sessions.

16 "PIT LANE" nominative accreditations

1 for the Team Manager

1 for each rider (maximum 4)

4 for mechanics

4 for the signalling area

2 for the people in charge of the refuelling

1 for the person in charge of the safety during the refueling (firefighter).

14 "PADDOCK" passes

For the staff of the Team, Partners, Guests, etc.

7 Car-park passes (6 parkings outside of the Paddock and 1 parking in the paddock) per motorcycle allowed to take part in the practice sessions.

5 – FACILITIES AND ALLOCATION OF PITS

Allocation of facilities:

e-mail: event@pha-michy.com

Each team will be allocated:

- 1 pit, within the limit of the number of pits available
- 1 space for the workshop in the working paddock (15 X 3 m),
- 1 space on support in the support paddock (of 180 m² approximatively).

The set up in the support/working paddocks must be approved by the organizer/promotor.

The private cars are strictly forbidden and must be parked in the admitted zones.

Allocation of pits is under the Organiser's exclusive responsibility.

Documents enclosed below:

- 6 – Horaires
- 7 – GPS
- 8 – Fuel characteristics
- 9 – FIM homologated fuel quick-fill system
- 10 – Short cuts
- 11 – Map of the circuit
- 12 – Location Map Accreditation Center
- 13 – Medical Center Access map
- 14 – Circuit access
- 15 – Waste water evacuation

In the case of dispute or controversy arising from the interpretation of the articles of these supplementary regulations, the French version only shall prevail.



8H SPA MOTOS – TIMETABLE V6 – 21/04/2025

TUESDAY JUNE 03th			
09:00		FIM ENDURANCE WORLD CHAMPIONSHIP	Paddock Waiting Area Opening
14:00		FIM ENDURANCE WORLD CHAMPIONSHIP	Hospitality Setup Start
20:00		FIM ENDURANCE WORLD CHAMPIONSHIP	Paddock Setup Start
WEDNESDAY JUNE 04th			
14:00	20:00		Accreditation Center Opening
09:00	18:00	FIM ENDURANCE WORLD CHAMPIONSHIP	Scrutineering
12:00		FIM ENDURANCE WORLD CHAMPIONSHIP	Paddock Setup END
18:00	18:30	FIM ENDURANCE WORLD CHAMPIONSHIP	Official Picture
THURSDAY JUNE 05th			
08:00	13:00		Accreditation Center Opening
14:00	20:00		
07:00	08:55	TRACKDAY	Waiver Signature
09:00	11:55	TRACKDAY	Private Practice
12:00	12:55	TRACKDAY	Break
13:00	17:55	TRACKDAY	Private Practice
16:00		FIM ENDURANCE WORLD CHAMPIONSHIP	Jury Meeting
18:30	19:15	FIM ENDURANCE WORLD CHAMPIONSHIP	Riders & Team Manager Briefing – Briefing Room
FRIDAY JUNE 06th			
08:00	13:00		Accreditation Center Opening
14:00	22:00		
08:15		FIM ENDURANCE WORLD CHAMPIONSHIP	Medical Inspection
08:30		FIM ENDURANCE WORLD CHAMPIONSHIP	Track Inspection
09:00	11:00	FIM ENDURANCE WORLD CHAMPIONSHIP	Free Practice Session
11:15	11:35	BENELUX TROPHY	Qualifying 1
13:00	13:20	BENELUX TROPHY	Qualifying 2
13:35	13:55	FIM ENDURANCE WORLD CHAMPIONSHIP	1 st Qualifying Practice Session – Blue Rider
14:05	14:25	FIM ENDURANCE WORLD CHAMPIONSHIP	1 st Qualifying Practice Session – Yellow Rider
14:35	14:55	FIM ENDURANCE WORLD CHAMPIONSHIP	1 st Qualifying Practice Session – Red Rider
15:10	15:55	BENELUX TROPHY	Race 1
16:25	16:45	FIM ENDURANCE WORLD CHAMPIONSHIP	1 st Qualifying Practice Session – Blue Rider
16:55	17:15	FIM ENDURANCE WORLD CHAMPIONSHIP	1 st Qualifying Practice Session – Yellow Rider
17:25	17:45	FIM ENDURANCE WORLD CHAMPIONSHIP	1 st Qualifying Practice Session – Red Rider
18:45	19:45	FIM ENDURANCE WORLD CHAMPIONSHIP	Pit Walk





SATURDAY JUNE 07th			
08:00	15:00		Accreditation Center Opening
08:15		FIM ENDURANCE WORLD CHAMPIONSHIP	Medical Inspection
08:30		FIM ENDURANCE WORLD CHAMPIONSHIP	Track Inspection
09:00	09:30	FIM ENDURANCE WORLD CHAMPIONSHIP	Warm Up
09:45	10:30	BENELUX TROPHY	Race 2
10:45	11:15	FIM ENDURANCE WORLD CHAMPIONSHIP	Pit Walk
11:25	11:30	FIM ENDURANCE WORLD CHAMPIONSHIP	Starting Grid
11:25		FIM ENDURANCE WORLD CHAMPIONSHIP	Pit Lane Open
11:26		FIM ENDURANCE WORLD CHAMPIONSHIP	4' Board
11:27		FIM ENDURANCE WORLD CHAMPIONSHIP	3' Board
11:28		FIM ENDURANCE WORLD CHAMPIONSHIP	2' Board
11:29		FIM ENDURANCE WORLD CHAMPIONSHIP	1' Board
11:30		FIM ENDURANCE WORLD CHAMPIONSHIP	Pit Lane Closed
11:30	12:00	FIM ENDURANCE WORLD CHAMPIONSHIP	Presentation of the Teams
11:32	12:00	FIM ENDURANCE WORLD CHAMPIONSHIP	Grid Access Open
11:32	11:40	FIM ENDURANCE WORLD CHAMPIONSHIP	Trophy presentation zone Setup
11:50	12:00	ANIMATION	Stunt
12:00	12:10	FIM ENDURANCE WORLD CHAMPIONSHIP	Grid evacuation
12:05	12:07	FIM ENDURANCE WORLD CHAMPIONSHIP	Starter ITV
12:10	12:15	FIM ENDURANCE WORLD CHAMPIONSHIP	Officials line up on the red carpet
12:10	12:15	FIM ENDURANCE WORLD CHAMPIONSHIP	Team line up for the Official Ceremony
12:15	12:17	FIM ENDURANCE WORLD CHAMPIONSHIP	Belgium National Anthem
12:20		FIM ENDURANCE WORLD CHAMPIONSHIP	5' Board
12:22		FIM ENDURANCE WORLD CHAMPIONSHIP	3' Board + Track Evacuation (except 1 mechanic per bike)
12:24		FIM ENDURANCE WORLD CHAMPIONSHIP	1' Board
12:24:30		FIM ENDURANCE WORLD CHAMPIONSHIP	30" Board
12:25		FIM ENDURANCE WORLD CHAMPIONSHIP	Green Flag
12:29		FIM ENDURANCE WORLD CHAMPIONSHIP	1' Board
12:29		FIM ENDURANCE WORLD CHAMPIONSHIP	Riders facing their machines
12:29:30		FIM ENDURANCE WORLD CHAMPIONSHIP	30" Board
12:29:30		FIM ENDURANCE WORLD CHAMPIONSHIP	FIM EWC Anthem
12:30		FIM ENDURANCE WORLD CHAMPIONSHIP	Race Start
20:30		FIM ENDURANCE WORLD CHAMPIONSHIP	Race Finish





ATLAS 2.4 • REAL TIME TRACKING

TECHNICAL SPECIFICATIONS • INSTALLATION ON A BIKE



ELECTRICAL SPECIFICATIONS

Black wire.....GND
 Brown wire.....+ 12 V
 White and black wires.....CAN • Not used

TECHNICAL SPECIFICATIONS

Battery.....1000 mAh
 Load.....3A
 Autonomy.....4h
 Weight.....140g
 Technology employed.....2.4 GHz
 Speed precision.....0.08 km/h
 Antenna types.....WIFI 2.4 GHz • GPS Active
 GNSS frequency used.....10 Hz
 Accelerometer sensitivity.....0.048 G

GNSS COMPATIBILITY
 BeiDou • Galileo • GLONASS • GPS

CONSUMPTION OF THE ATLAS 2.4 MODULE
 12 V • 200 mAh

The ATLAS 2.4 module does not have an ON/OFF button. As soon as it is supplied with 12V, it starts up. When the 12V is no longer available, the backup battery takes over and will turn off automatically after several hours.

ATLAS ANTENNA

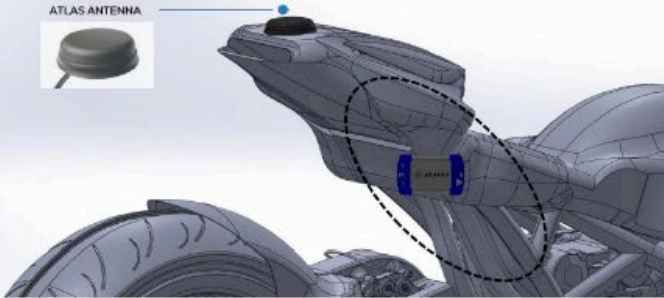

IMPORTANT MOUNTING PROCEDURE

The ATLAS 2.4 box must be installed inside the motorbike and a dry place fixed in such a way that it remains stationary. The ATLAS 2.4 box need anti-vibration base. To be efficient and safe, we ask to all teams to supply their own brackets for the system. The antenna of the ATLAS 2.4 have to be mounted at the back of the motorbike saddle, with the provided mounting screw.



ATLAS 2.4 • REAL TIME TRACKING

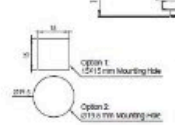
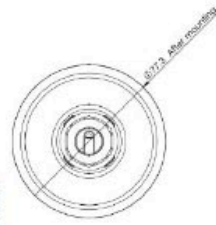
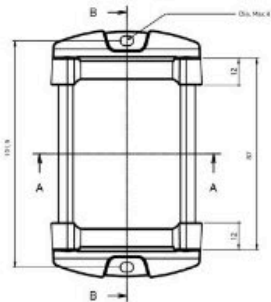
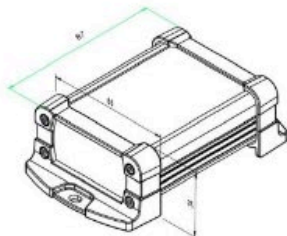

08- FUEL CHARACTERISTICS

Octane 98 : ELF Unleaded 98 (in compliance with EN228 standard)

NB : Mandatory for Superstock and Production categories (Octane 102 unauthorized).

Octane 102 : ELF Moto2 FIM



TECHNICAL DATA SHEET

« Our formulation guarantees you a fuel with a high engine octane rating (RON) and with properties that remain stable over time. This constant and optimum search for quality ensures high-level performance, in conformity with FIM regulations. »

USES

ELF MOTO2 FIM is an unleaded fuel suitable for naturally aspirated 4-stroke engines as well as for 2-stroke engines. This fuel is designed exclusively for high and very high speeds engines used in motorcycle racing.

ELF MOTO2 FIM is the cost effective FIM compliant racing fuel for bikers. Compared to pump fuels, this fuel guarantees stable tuning and performance gains at an affordable price.

ELF MOTO2 FIM is particularly suited to competitions like:

- Superbike / Supersport
- Endurance / Enduro
- MX/SX,
- Supermoto...

PROPERTIES

		Typical data	
		ELF MOTO2 FIM	Unleaded 98 usual
Octane number	RON	101,0	97,0 – 99,0
	MON	88,5	> 85,0
Density at 15°C	kg/m ³	750,0	720 – 775
Vapour Pressure at 37,8°C	kPa	68	20 – 48
Distillation	% v/v, at 100°C	50 – 71	46 - 71
Air Fuel Ratio at stœchiometry		14,05	
Oxygen content	% m/m	≤ 2,70	< 2,70
Sulphur content	mg/kg	< 10,0	< 10,0
Lead content	g/L	< 0,005	< 0,005
Benzene content	% v/v	1,0	< 1,0

9- SYSTEME DE REMPLISSAGE HOMOLOGUE FIM

4

RACCORD / SOCKET
P/N 100041566

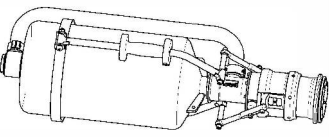

ABOUT / PLUG
P/N 100041567

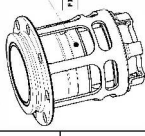

BOUCHON ABOUT / PLUG CAP
P/N 100041568



ABOUT VIDANGE / DRAIN PLUG
P/N 100042532

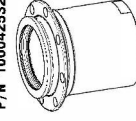

KIT DE BASE EWC / EWC BASE KIT
P/N 100042845

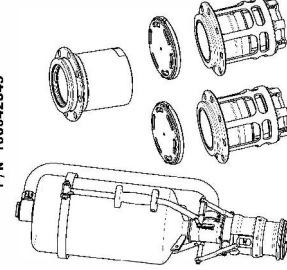

REVISION	DATE	DESCRIPTION
0.5	10-06-24	REVISION
0.4	10-06-24	REVISION
0.3	10-06-24	REVISION
0.2	10-06-24	REVISION
0.1	10-06-24	REVISION

SAF45 / FIM & PLUG
RACCORD / SOCKET
PLAN D'APPLICATION - APPLICATION DRAWING

8 000 115 196 J

3

POSITION ACCOUPLEE - CONNECTED POSITION

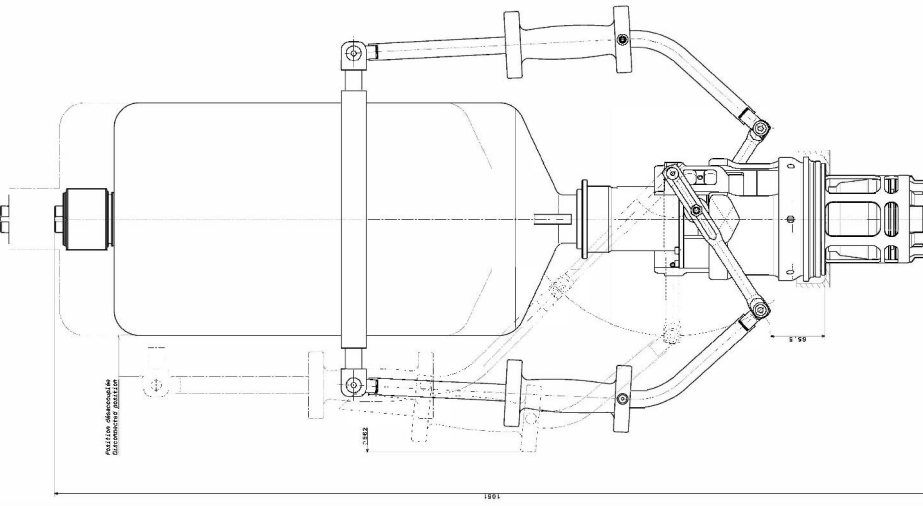

IMPLANTATION ABOUT DIRECT AU RESERVOIR
PLUG ABOUT DIRECTLY ON RESERVOIR

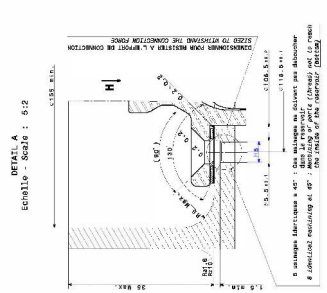

IMPLANTATION ABOUT VIDANGE EVENT
LOCATION OF DRAIN PLUG

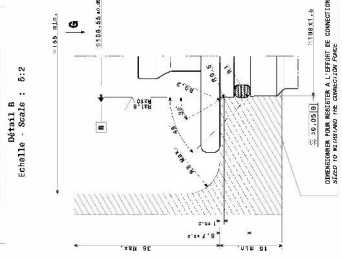

Coupe partielle D-D - CUT D-D
Echelle - Scale : 5:2
3 usages identiques
3 identical positions

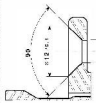

2

POSITION DESACCOUPLEE - DISCONNECTED POSITION

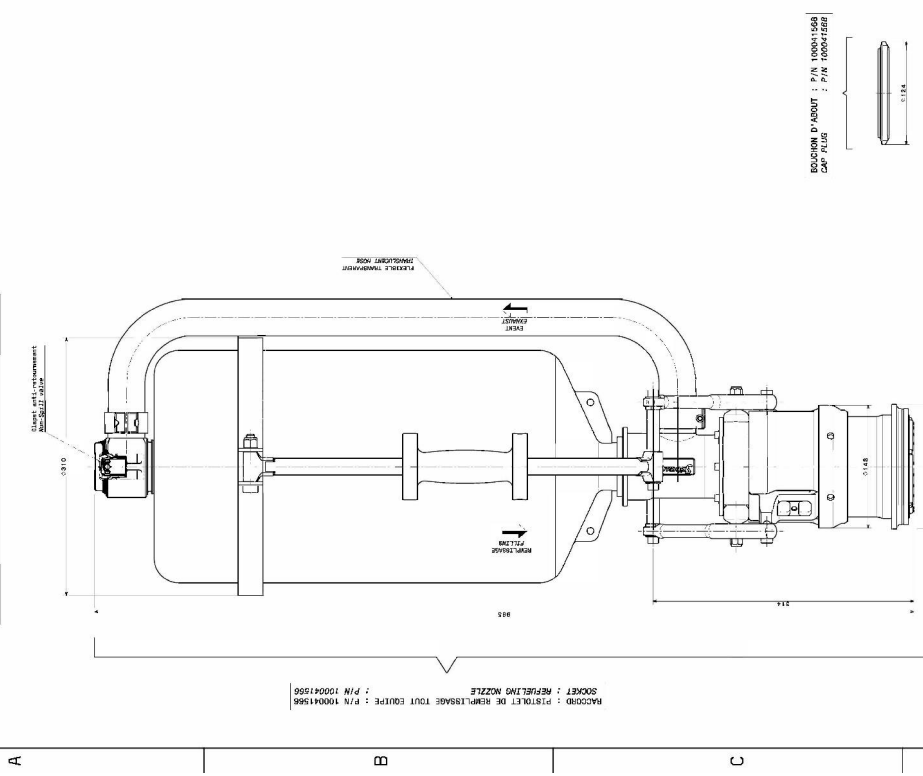

BOUCHON D'ABOUT / CAP PLUG
P/N 100041568
P/N 100041568



IMPLANTATION ABOUT DIRECT AU RESERVOIR
PLUG ABOUT DIRECTLY ON RESERVOIR
Vue subvante H - View from H

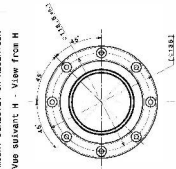

IMPLANTATION ABOUT VIDANGE EVENT
LOCATION OF DRAIN PLUG
Vue subvante B - View from B

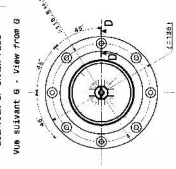

ABOUT DIRECT AU RESERVOIR - MATERIAL NUMBER : P/N 100041567*
PLUG DIRECTLY ON RESERVOIR - MATERIAL ON 05090 : P/N 100041567*

ABOUT VIDANGE EVENT - P/N 100042532
DRAIN PLUG : P/N 100042532

10 –SHORT CUTS



CIRCUIT DE SPA
FRANCORCHAMPS

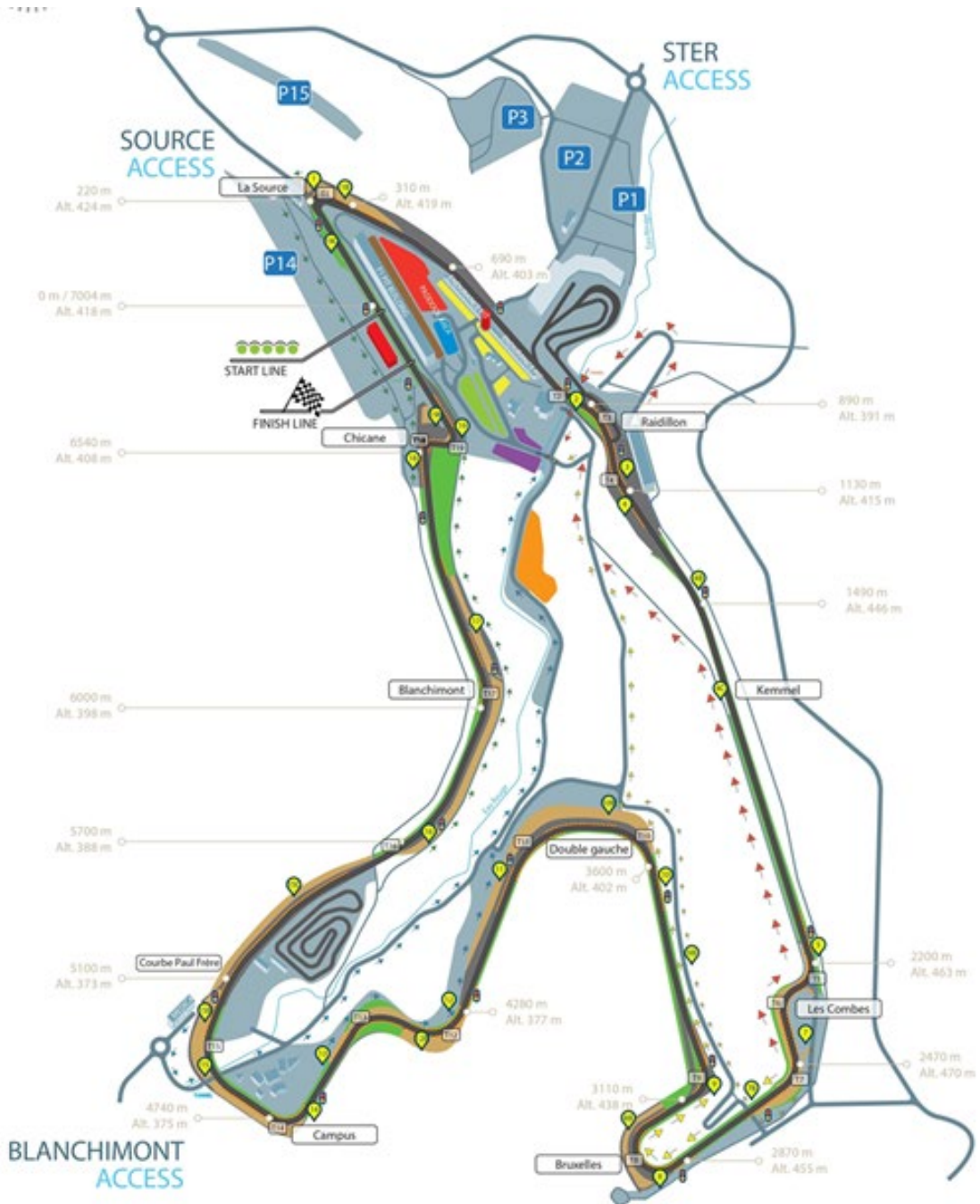

11- MAP OF THE CIRCUIT

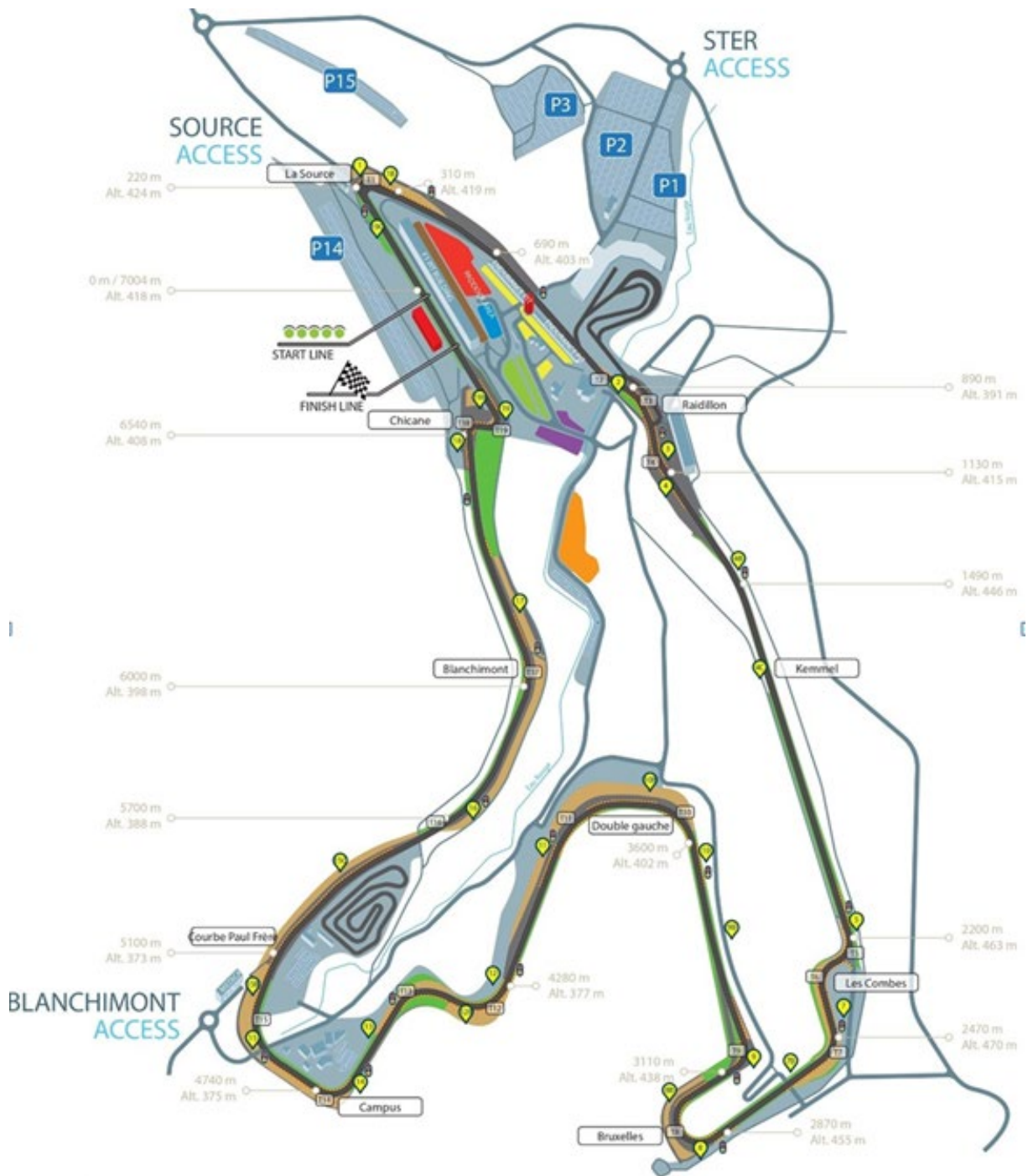

12- LOCATION MAP ACCREDITATION CENTER

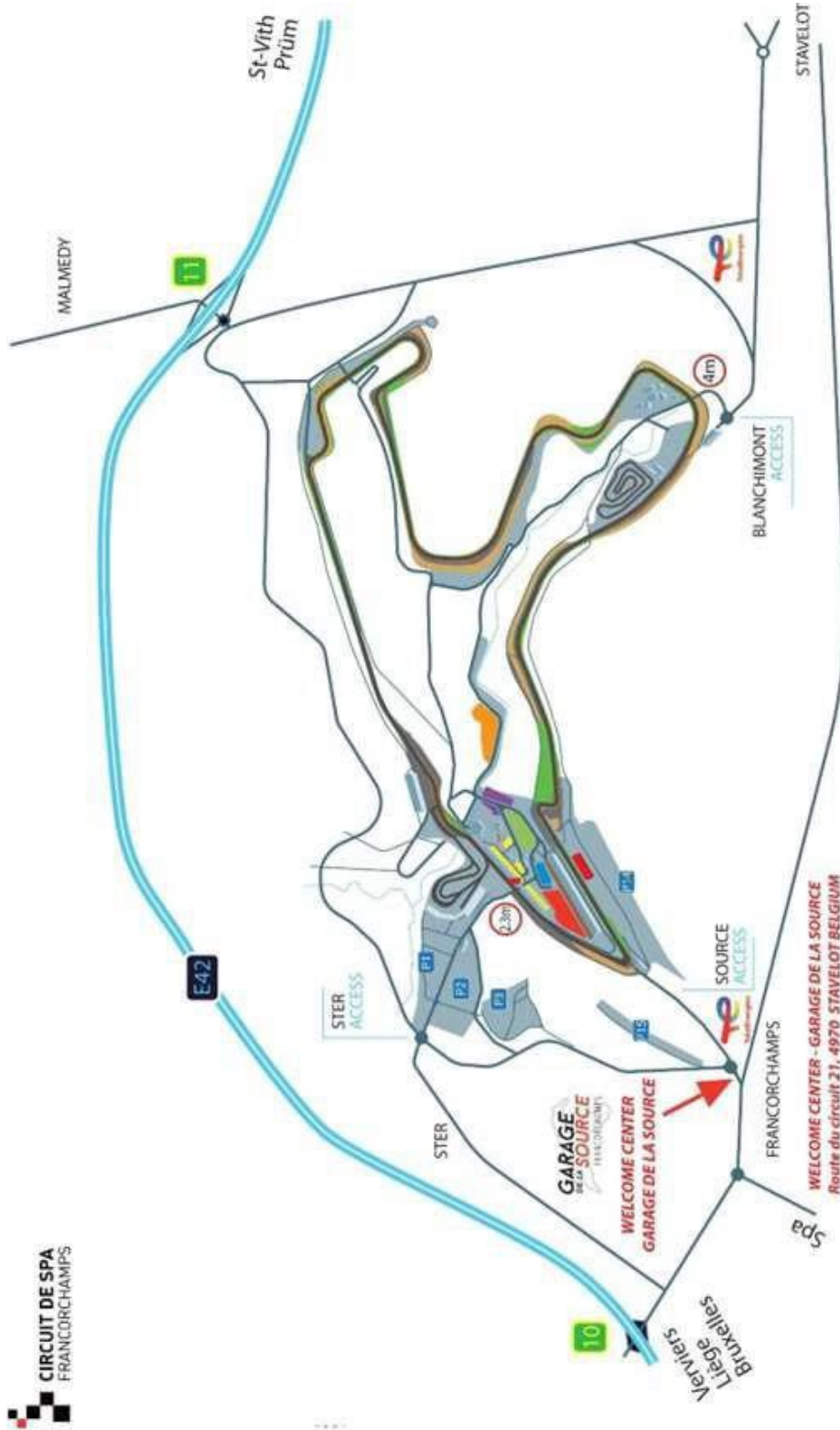

TIMING WELCOME
 Wednesday 4 June :
 de 14h00 à 20h00
 Thursday 5 June :
 08h00 - 13h00
 Thursday 5 June :
 14h00 - 20h00
 Friday 6 June : 08h00
 - 13h00
 Friday 6 June : 14h00
 - 22h00
 Saturday 7 June :
 08h00 - 15h00

13 – MEDICAL CENTER ACCESS MAP

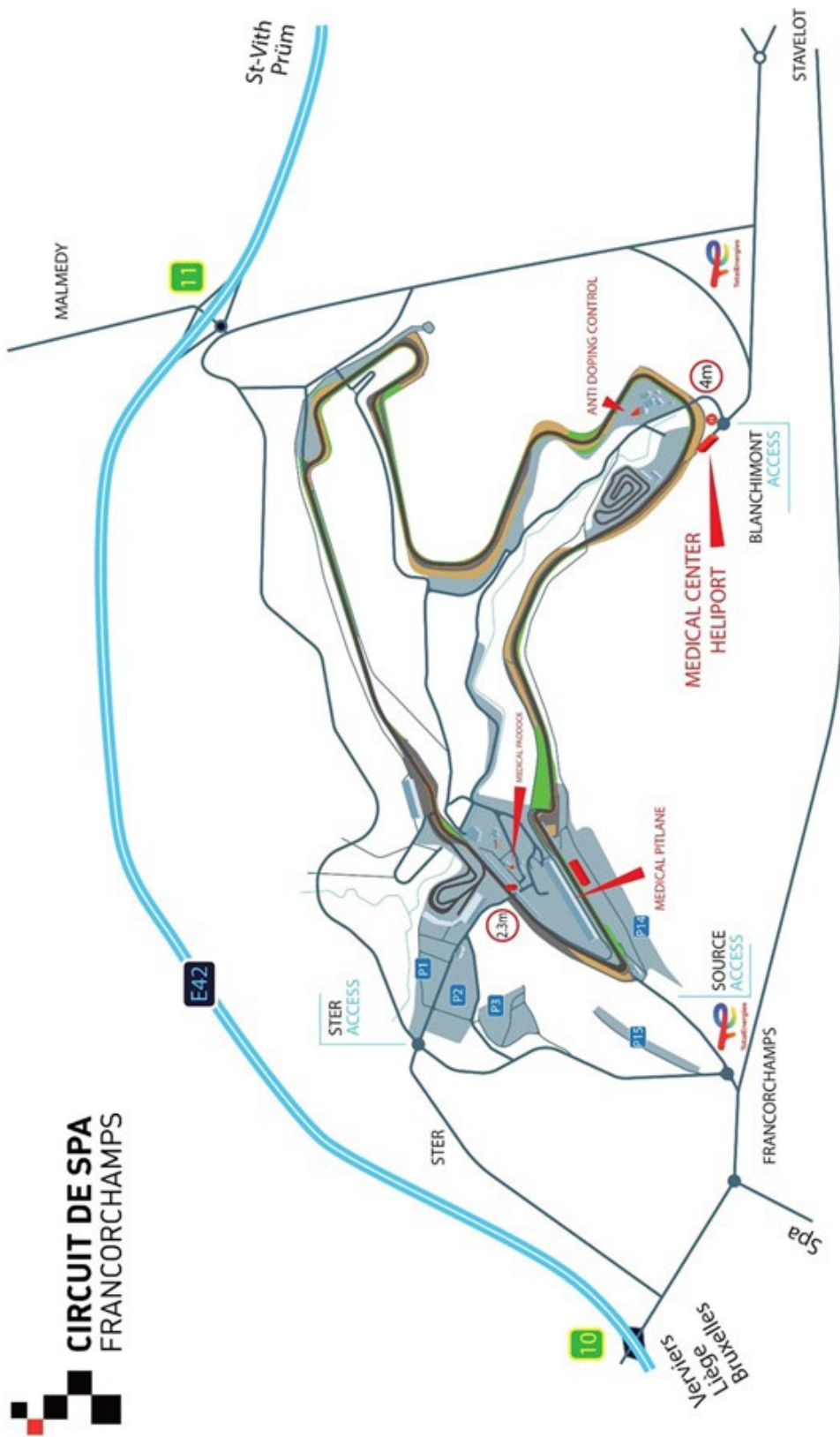

14-CIRCUIT ACCESS



15 – Waste water evacuation